

Index No.	Part No.	Package / Order Reference	Description
1.	55-143072-000	55-860056-000	Pkg. 360 Controller Assembly - StringPin UL
	55-143026-000	55-860057-000	Pkg. 360 Controller - StringPin CE
1a.	55-143008-230	55-860059-230	High Voltage PCB (230V)
	55-143008-380	55-860059-380	High Voltage PCB (380V)
1b.	11-696982-000	55-860060-000	Power Supply (24V)
1c.	*11-671007-xxx		Power Contactor -12A
1d.	*11-671008-xxx		Contact Block - NC/NO
1e.	*11-671009-xxx		Surge Suppressor 24V
1f.	11-696694-000		Controller - Pilz (CE Only)
1g.	11-616037-000		Holder, Contact Block - Emergency Stop
1h.	11-616036-000		Button - Emergency Stop
1i.	11-685056-000		Fuse 250V .5A Fast Blo
1j.	11-685061-000	57-861636-000	Fuse 250V 1.0A Slow Blow - Pkg of 4 (Not Shown)
1k.	11-685062-000	14-860242-000	Fuse 250V 2.0A Slow Blow - Pkg of 5 (Not Shown)
1l.	11-685067-000	57-861874-000	Fuse 250V 3.0A Slow Blow - Pkg of 4 (230V Only)
2.	55-143054-400	55-860058-400	Slide Out Assembly - StringPin Ver 1.0 (Replaced by 55-860058-401)
	55-143054-401	55-860058-401	Slide Out Assembly - StringPin Ver 1.1.27 (Replaced by 55-860064-400)
	55-143090-400	55-860064-400	Slide Out Assembly - StringPin Ver 1.1.27
2a.	11-685060-000	47-862854-000	Fuse 250V 3.15 A Fast Blo - Pkg of 5 (Not Shown)

* xxx - 000 or 100 (Do Not Mix)

360 Controller

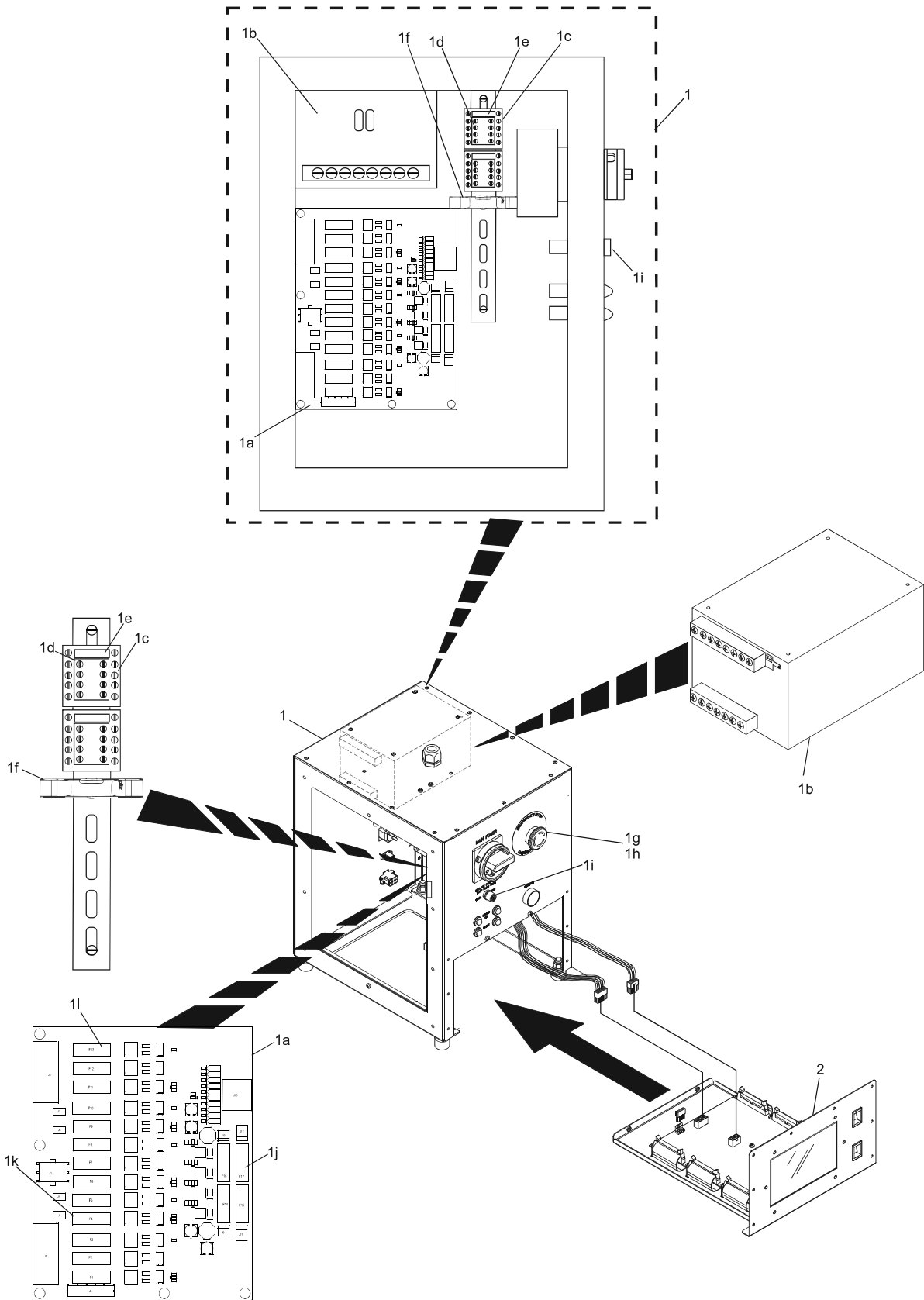

360 Controller