

Index No.	Part No.	Description	Index No.	Part No.	Description
1.	47-024735-009	R.H. Transport Band Side Frame Complete	33.	11-053909-000	V Belt (10 mm x 6 mm x 2560 mm) - use with 110 mm pulley
2.	47-024736-009	L.H. Transport Band Side Frame Complete	34.	47-025049-004	V-Belt Pulley (125 mm)
3.	47-020942-003	Roller	35.	47-023915-004	Rubber Spacer
4.	47-020943-004	Roller Bushing	36.	11-051746-001	Locknut (3 mm)
5.	11-051858-001	Retaining Ring (15 mm)	37.	11-052929-000	Socket Flat Hd. S.S. Screw (10 mm x 50 mm)
6.	47-861011-001	Flat Washer (17 mm) Pkg. of 10	38.	11-052930-000	Socket Flat Hd. Cap Screw S.S. (10 mm x 60 mm)
7.	11-051565-009	Socket Hd. Machine Screw (10 mm x 110 mm)	39.	47-861042-001	Rubber Washers (Pkg of 10)
	11-051569-009	R.O. Socket Hd. Machine Screw (M10 x 120 mm) Pkg. of 10	40.	11-052150-001	47-024740-004 Finishing Washer (5.3 mm x 28 mm x 10.2 mm)
8.	11-051745-001	Lock Nut (10 mm)	41.	47-274332-002	Bearing Block Repair Kit
9.	11-054225-000	N.A. Bearing w/Conical Insert - See index 24	42.	11-051770-001	Lock Washer (10 mm)
10.	47-276153-000	N.A. Repair Nut - see index 46	43.	11-050326-001	Rivot Nut
11.	11-051045-001	Hex Hd. Machine Screw (10 mm x 30 mm)	44.	11-052064-001	N.A. Flat Washer (15 mm)
12.	47-023981-002	Roller Assembly Complete, (front) 3 Stud End Cap - Replaces 2 Stud End Cap Roller Assembly	44.	47-861014-001	R.O. Pkg. of 10 Flat Washer (15 mm)
13.	47-860013-000	Pkg. O-Rings (Qty. of 4)	45.	47-025178-003	Bearing (3-stud)
14.	47-020908-003	End Cap w/Bearing (2 Stud Front rollers Only)	46.	11-051902-001	Retaining Ring (52 mm)
15.	11-052003-001	Flat Washer (8.4 mm)	47.	11-051561-001	Hex Head Cap Screw (3 mm x 30 mm)
16.	11-051744-001	Locknut (8 mm)	48.	47-026370-009	Spacer Bushing (21 mm) - Qty. of 2
17.	47-023933-004	Shaft - Front	49.	11-051743-001	Hex Nut (6 mm)
18.	47-026371-009	Spacer Bushing (13.5 mm) - Qty. of 2	50.	47-276153-009	Side Frame Repair Kit (contains 1 each index 51 and index 52)
19.	11-052676-001	Roll Pin (3 mm x 30 mm)	51.	11-052930-000	N.A. Screw Socket Flat Head- see index 50
20.	11-635201-000	Transport Band Carpet (2020 mm x 1440 mm)	52.	47-276153-000	N.A. Repair Nut - see index 50
	11-635201-100	Certified Transport Band Belt			
21.	47-025051-001	Odd Lane Short Roller Assembly Complete (rear)			
22.	47-024905-001	Even Lane Short Roller Assembly Complete (rear)			
23.	47-024094-003	Housing			
24.	11-430055-000	Deep Groove Ball Bearing			
25.	47-024093-004	Threaded Rod (10 mm x 140 mm)			
26.	11-052050-001	Flat Washer (10.5 mm)			
27.	47-024309-004	Spring			
28.	11-051703-001	Hex Nut (10 mm)			
29.	11-051853-001	Retaining Ring (20 mm)			
30.	47-023959-003	Front Board Assembly Complete			
31.	47-024741-004	Flat Washer (10.5 mm)			
32.	47-025175-003	L.H. Rear Board Assembly - Complete (odd lane)			
	47-025176-003	R.H. Rear Board Assembly - Complete (even lane)			

N.A. = No Longer Available
R.O. = Replacement Option

Transport Band Assembly (10 mm Side Frames) Short Pit Machines Series 208 and Above

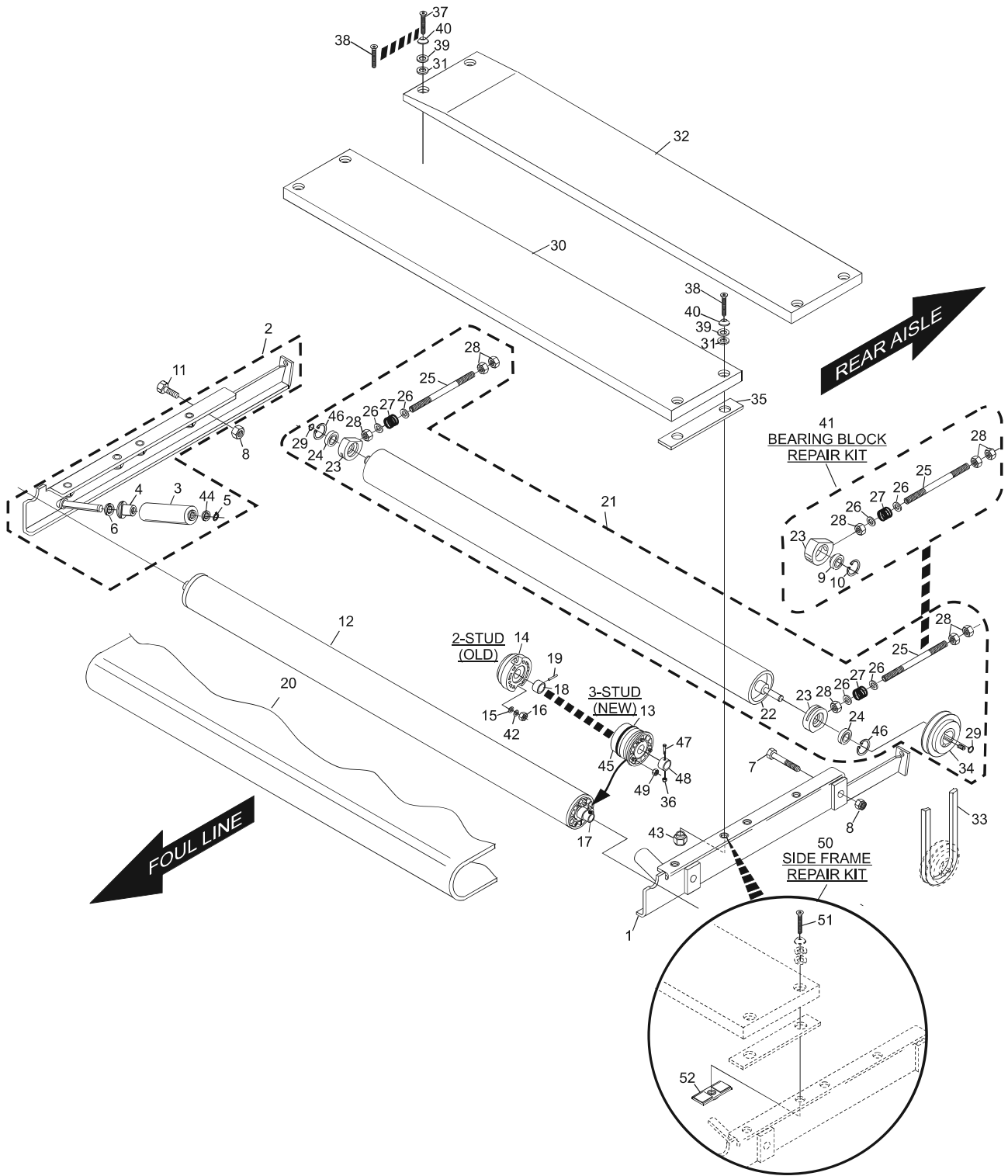

**Transport Band Assembly (10 mm Side Frames)
Short Pit Machines Series 208 and Above**