

| Index | | | Index | | |
|-------|----------------|---|-------|--------------------|---|
| No. | Part No. | Description | No. | Part No. | Description |
| 1. | 47-094344-003 | Front Pulley Shaft | 54. | 47-094349-001 | Front Shaft Assembly |
| 2. | 47-091905-003 | R.H. Turn Plate | 55. | 47-091854-004 | N.A. Vinyl (long pit version) |
| 3. | 11-051038-001 | Hex Hd. Cap Screw (8 mm x 16 mm) | | 47-092345-004 | R.O. Vinyl (short pit version) |
| 4. | N.A. | Distributor Frame Complete | 56. | 47-092476-004 | Pin Turn Device (left-hand) |
| 5. | 47-090547-004 | Spur Gear w/25 mm Collar | 57. | 47-092475-004 | Pin Turn Device (right-hand) |
| | 47-275746-009 | Two Piece Gear Kit | 58. | N.A. | Slider Only (hardware not included) |
| 6. | 47-092300-004 | Polycord Roll (12 mm dia. x 44 meters Lg.) | | 47-095609-002 | R.O. Slider Only (hardware not included) |
| | 47-092300-005 | Polycord Roll (13 mm dia. x 20 meters Lg.) | 59. | 47-092265-003 | Extension Rails (L.H./R.H., for Dual Feed Distributor, for short pit) |
| 7. | 11-051770-001 | Lockwasher (8 mm) | | 47-092249-002 | N.A. L.H./R.H. Extension Rails for Dual Feed Distributor (long pit) |
| 8. | 11-051744-001 | Hex Nut (8 mm) | | 47-093901-002 | R.O. L.H./R.H. Distributor Extension Dual Feed (long pit) |
| 9. | 47-090989-002 | Double Pulley | 60. | 47-094712-003 | Bracket |
| 10. | 11-053903-000 | V-Belt (13 mm x 8 mm x 1375 mm) | | ***47-274806-009 | Guide Rail Extension Kit |
| 11. | 11-054102-001 | N.A. Spacer Flat Washer (25 mm) | 61. | 47-092479-003 | R.H. Guide Bracket |
| | 47-861028-001 | R.O. Shim Washers Pkg. of 10 | 62. | 11-051018-001 | Hex Head Cap Screw (6 mm x 20 mm) |
| 12. | 11-051856-001 | Retaining Ring (25 mm) | 63. | 47-093760-002 | Distributor Station (pin no. 7, steel) |
| 13. | 47-091904-003 | Turn Plate (left-hand) | | 47-091890-002 | Distributor Stations (pin nos. 2,3,8,9, and 10, steel) |
| 14. | N.A. | Dual Feed Distributor Assembly Complete | | 47-092211-002 | Distributor Stations (pin nos. 1 and 6, steel) |
| 15. | N.A. | Pulley Holder (left-hand) | 64. | 47-092186-003 | Bracket |
| 16. | 47-092193-003 | Pulley Holder (right-hand) | 65. | 47-092478-003 | L.H. Guide Bracket |
| 17. | 47-092271-004 | N.A. Pin Guide | 66. | 47-095050-003 | Plastic Bearing |
| 18. | 47-091277-002 | Slider Mount | 67. | 47-093910-003 | R.H. Shark Rail |
| 19. | **N.A. | Slider Assembly | 68. | 47-093911-003 | L.H. Shark Rail |
| 20. | 47-091284-002 | Slider Assembly Complete | 69. | 47-092238-003 | S.O. R.H. Distributor Rail - long |
| 21. | 47-097417-000 | A/P Pin Guide/Stop | 70. | 47-092239-003 | S.O. L.H. Distributor Rail - long |
| | 47-090969-003 | Pin Stop | 71. | 47-093934-003 | Pin Deflector Shoe - Single Piece |
| 22. | 11-051520-001 | Socket Hd. Cap Screw (6 mm x 30 mm) | 72. | 47-092454-004 | Rail - short (front) |
| 23. | 11-051515-001 | Socket Hd. Cap Screw (6 mm x 18 mm) | 73. | 47-092242-002 | S.O. L.H. Plate - upper |
| 24. | 11-054449-000 | Hex Hd. Self-Tapping Screw (K70 x 18 mm) | 74. | 47-095146-003 | S.O. L.H. Plate - lower |
| 25. | 11-052019-001 | Flat Washer (8.4 mm) | 75. | 47-093883-004 | Shaft |
| 26. | 11-051852-001 | Retaining Ring (17 mm) | 76. | 47-094345-003 | N.A. Middle Shaft |
| 27. | 11-052804-001 | Set Screw (6 mm x 8 mm) (for Pulley Hub) | 77. | 47-095144-003 | S.O. R.H. Plate - lower |
| 28. | 11-051546-001 | Hex Hd. Cap Screw (5 mm x 40 mm) | 78. | 47-092243-002 | R.H. Plate - upper |
| 29. | 11-052039-001 | Flat Washer (5.3 mm) | 79. | 47-092474-004 | N.A. Pin Turn Pad |
| 30. | 11-051742-001 | Locknut (5 mm) | 80. | 47-092237-003 | S.O. L.H. Front Rail |
| 31. | 47-092415-003 | Pulley w/Bearing | 81. | 47-092234-003 | S.O. R.H. Front Rail |
| 32. | 47-092496-004 | N.A. Pin Guide | 82. | 47-094232-004 | Rubber Grommet |
| 33. | 11-051743-001 | Locknut (6 mm) | 83. | 11-052048-001 | Flat Washer (6.4 mm) |
| 34. | 11-052037-001 | Flat Washer (6.4 mm) | 84. | ****47-095173-003 | Pin Deflector Shoe, Left-hand (For 2-piece Shoe) |
| 35. | 47-092202-004 | Shaft | 85. | **** 47-095172-003 | Pin Deflector Shoe, Right-hand (For 2-piece Shoe) |
| 36. | 47-092203-004 | Shaft | 86. | 47-275730-009 | Distributor Repair Kit |
| 37. | 47-092199-003 | N.A. Bracket | 87. | 47-095724-003 | Distributor Bracket Ten Pin Side |
| 38. | 47-091512-003 | N.A. Flat Spring | 88. | 47-095725-003 | Distributor Bracket Seven Pin Side |
| 39. | 47-092206-004 | Shaft | | | |
| 40. | 47-093874-004 | Clamp | | | |
| 41. | 47-093547-004 | Gear | | | |
| 42. | 47-093741-002 | S.O. Dust Pan | | | |
| 43. | 47-093771-004 | Felt Pad | | | |
| 44. | *11-676027-000 | N.A. Contact Cement - quart | | | |
| | *11-676047-000 | Contact Cement - gallon | | | |
| 45. | 47-093587-004 | Dowel Pin (Pkg. of 25) | | | |
| 46. | 47-093863-003 | Round Belt Pulley | | | |
| | 47-275748-009 | 2-Piece Pulley Kit | | | |
| 47. | 47-094353-004 | PVC Spacer | | | |
| 48. | 47-094347-003 | Bearing Shell | | | |
| 49. | 47-094346-003 | Bearing Shell w/Shoulder | | | |
| 50. | 47-094351-003 | Washer | | | |
| 51. | 11-430013-000 | Bearing | | | |
| 52. | 11-051010-001 | Hex Hd. Cap Screw (8 mm x 20 mm) | | | |
| 53. | 11-052006-001 | Washer (8.4 mm) | | | |

Dual Feed Distributor

N.A. = No Longer Available
R.O. = Replacement Option
S.O. = Special Order

* Not Illustrated

** Includes index nos. 24, 25 & 58.

*** Includes index nos. 60, 33, 62, & 34.

**** A complete two piece shoe requires: 1 each of 47-095172-003 R.H. shoe and 1 each of 47-095173-003 L.H. shoe

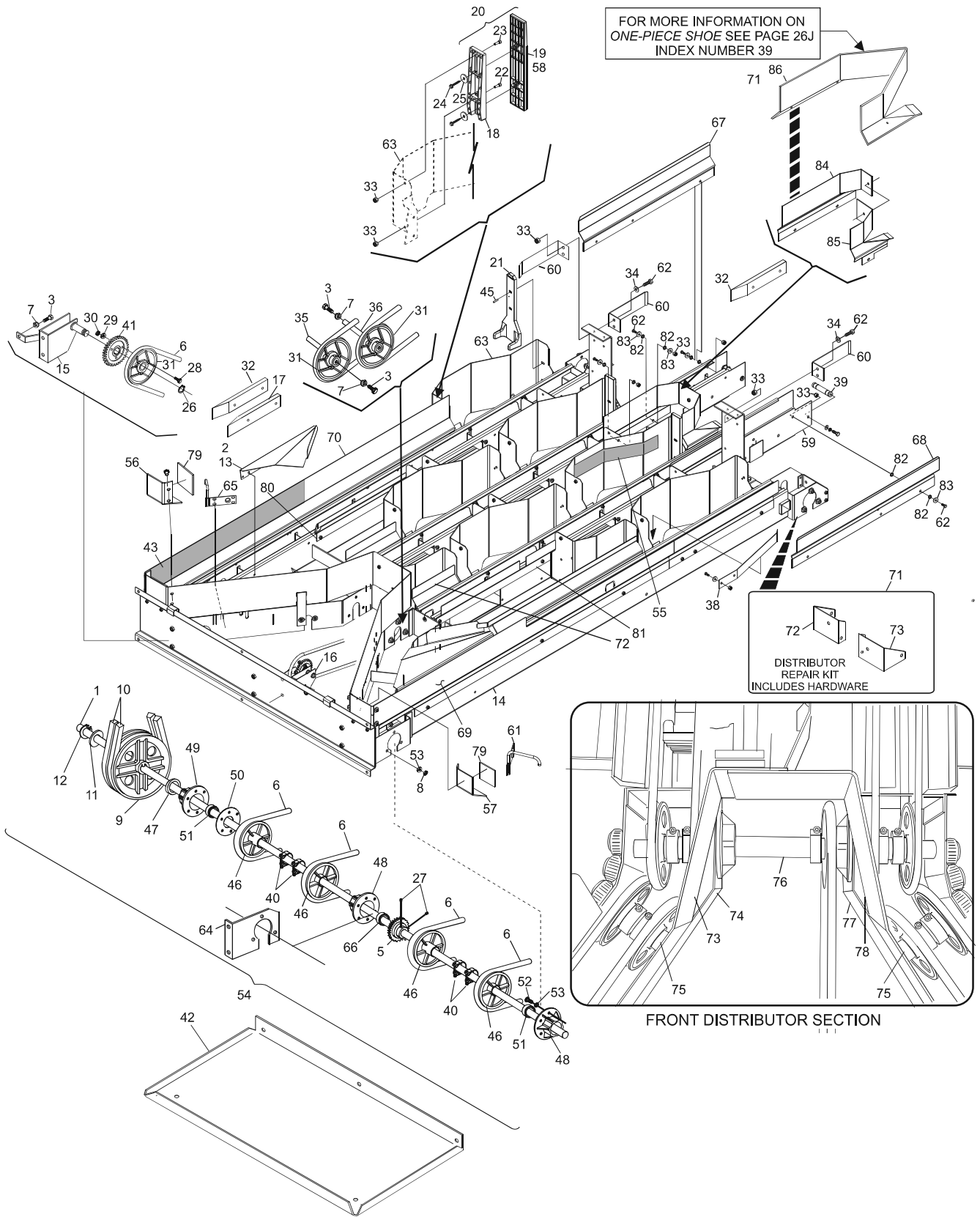

Dual Feed Distributor